

Dial Calipers

Rugged construction – High accuracy – Patented shockproof design – Ideal for use in the workshop.

Models TESA CCMA-M

Easy-to-read dial calipers – Slider with metal dial housing – Models with a 200 or 300 measuring span fitted with a thumb roller.



DIN 862
(Style 1AR)

≤100 mm = 20 μm
>100 mm = 30 μm

Hardened stainless steel

32 mm diameter rotating dial with lock

Slider with locking screw

Steel gear mechanism, hardened and ground

Patented shockproof design

Suited plastic case

Identification number

Inspection report with a declaration of conformity

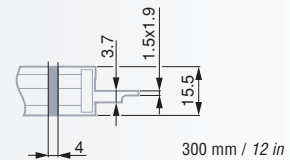
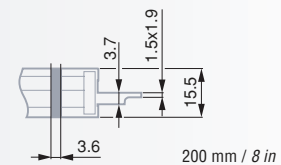
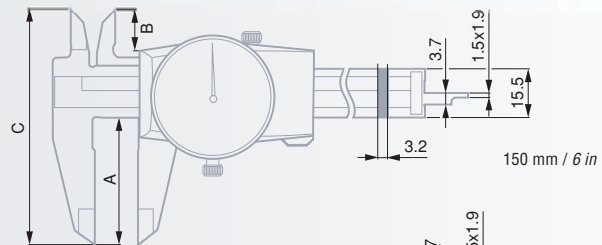
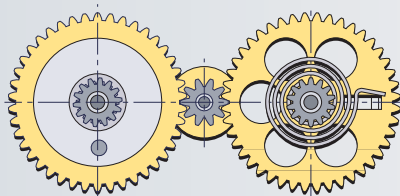
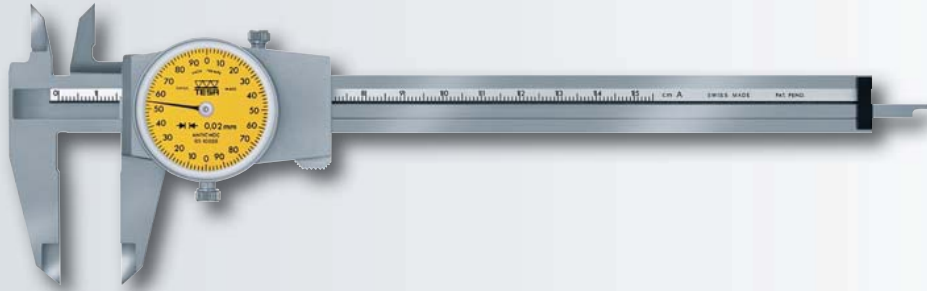

No	Steel gear mechanism	Patented shockproof design	32 mm diameter rotating dial	Slider with locking screw	Thumb roller	A mm	B mm	C mm
00510008	0 ÷ 150 mm	0,02 mm	2 mm	–	–	40	13	74
00520002	0 ÷ 6 in	0.001 in	0.1 in	–	–	40	13	74
00510045	0 ÷ 200 mm	0,02 mm	2 mm	●	●	50	18,6	89,5
00510046	0 ÷ 300 mm	0,02 mm	2 mm	●	●	64	20,6	105,5
<i>Optional Accessory</i>								
00560013	Depth foot for models 150 mm/6 in (also see page B-24)							

Model ETALON 125

Slider with metal dial housing – 1 mm per pointer revolution.

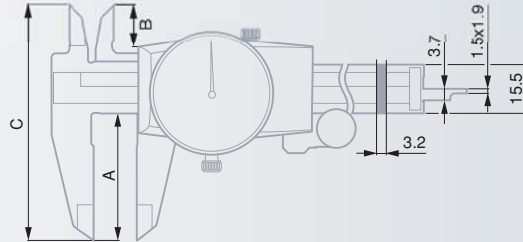
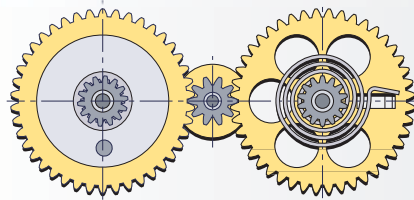

075115821



0 ÷ 150 mm



0,02 mm



1 mm



without thumb roller

Optional Accessory

00560013 Depth foot (also see page B-24)

Model TESA CCMA-M, 0,01 mm

Slider with metal dial housing – 1 mm per pointer revolution.

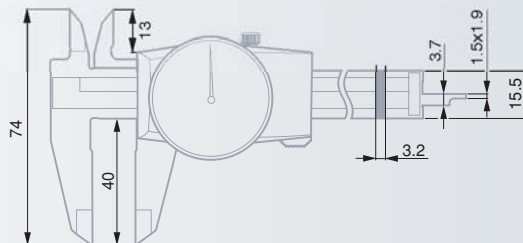
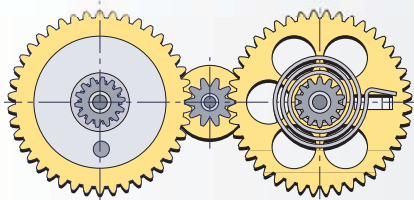
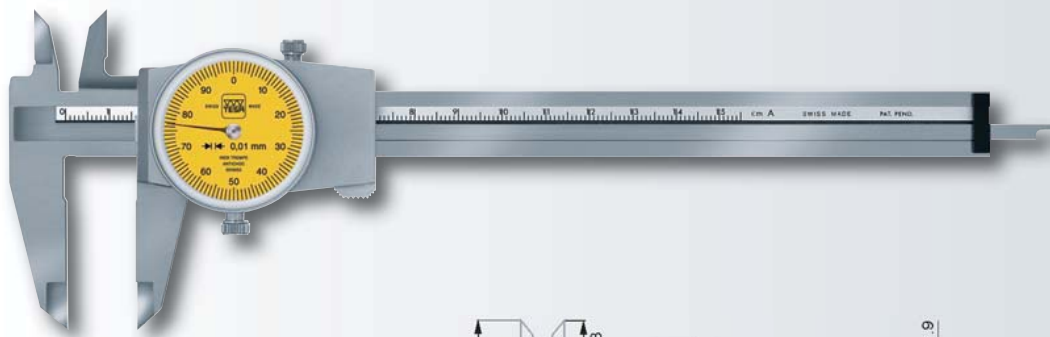

00510050



0 ÷ 150 mm



0,01 mm



1 mm

Optional Accessory

00560013 Depth foot (also see page B-24)

