

MarCal 16 EWR

Digital Caliper



FUNCTIONS

- ON/OFF
- AUTO-ON / OFF
- RESET (set display to zero)
- PRESET (for entering a numerical value)
- Reversal of counting direction
- mm/inch
- LOCK function (key lock)

FEATURES

- High contrast analog display
- Locking screw above
- Lapped guideway
- Measuring blade for inside measurements
- Slide and beam made of hardened stainless steel
- Step measuring function
- Immediate measurements due to the Reference System
- Raised guideway for the protection of the scale
- Excellent resistance against dust, coolants and lubricants
- Dirt wipers are integrated in the slide
- **Digit height:** 11 mm
- **Data interface:** none
- **Energy supply:** Battery life approx. 3 years
- **IP protection category:** IP 67
- **Package contains:** battery, instruction manual, case

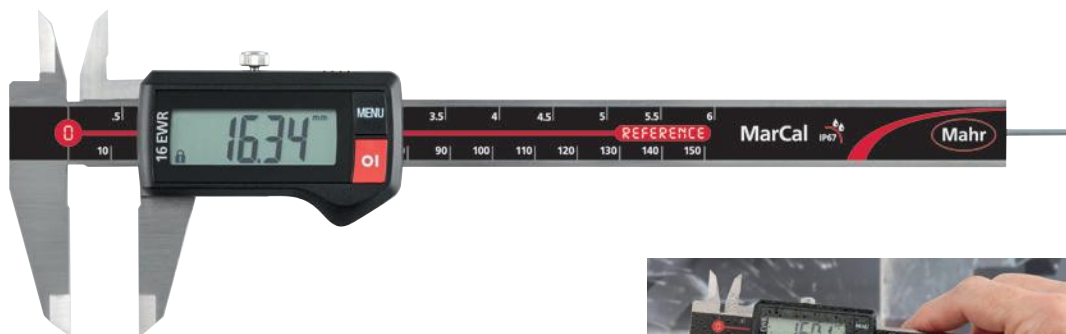

TECHNICAL DATA

Order no.	Type	Measuring range		Numerical increment	Error limit		Standard	Depth rod	Friction wheel
		mm	inch		mm	inches (text)			
4103300	16 EWR	0 -150	0 -6"	0.01 / .0005"	0.03	.001"	DIN 862	round	
4103301	16 EWR	0 -150	0 -6"	0.01 / .0005"	0.03	.001"	DIN 862	round	•
4103302	16 EWR	0 -150	0 -6"	0.01 / .0005"	0.03	.001"	DIN 862	rectangular	
4103303	16 EWR	0 -150	0 -6"	0.01 / .0005"	0.03	.001"	DIN 862	rectangular	•
4103304	16 EWR	0 -200	0 -8"	0.01 / .0005"	0.03	.001"	DIN 862	rectangular	
4103305	16 EWR	0 -200	0 -8"	0.01 / .0005"	0.03	.001"	DIN 862	rectangular	•
4103306	16 EWR	0 -300	0 -12"	0.01 / .0005"	0.04	.0015"	Factory standard		
4103307	16 EWR	0 -300	0 -12"	0.01 / .0005"	0.04	.0015"	Factory standard		•

Order no.	a	b	c	d	e
	mm	mm	mm	mm	mm
4103300	10	40	16	235	16
4103301	10	40	16	235	16
4103302	10	40	16	235	16
4103303	10	40	16	235	16
4103304	10	50	19	285	16
4103305	10	50	19	285	16
4103306	14	64	19	388	16
4103307	14	64	19	388	16

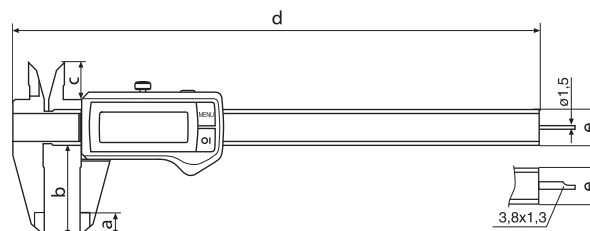

ACCESSORIES

Order no.	Product name	Type
4102020	Depth bridge (75 x 7 mm)	16 Em
4102520	Battery 3 V, CR 2032	

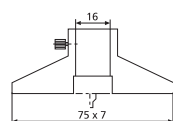

16 Em

MarCal 16 EWR

Digital Caliper



FUNCTIONS

- ON/OFF
- AUTO-ON / OFF
- RESET (set display to zero)
- mm/inch
- LOCK function (key lock)
- DATA (data transmission via connection cable)



FEATURES

- High contrast analog display
- Locking screw above
- Lapped guideway
- Measuring blade for inside measurements
- Slide and beam made of hardened stainless steel
- Step measuring function
- Immediate measurements due to the Reference System
- Raised guideway for the protection of the scale
- Excellent resistance against dust, coolants and lubricants
- Dirt wipers are integrated in the slide
- SoftwareMarCom Professional free download: www.mahr.com/marcom (only for Mahr data cables and wireless systems with USB and RS232 interface)
- **Digit height:** 8.5 mm
- **Data interface:** USB, Opto RS232C, Digimatic
- **Energy supply:** Battery life approx. 3 years
- **IP protection category:** IP 67
- **Package contains:** battery, instruction manual, case

TECHNICAL DATA

Order no.	Type	Measuring range		Numerical increment	Error limit		Standard	Depth rod	Friction wheel
		mm	inch		mm	inches (text)			
4103064	16 EWR	0-150	0-6"	0.01 / .0005"	0.03	.001"	DIN 862	round	
4103065	16 EWR	0-150	0-6"	0.01 / .0005"	0.03	.001"	DIN 862	round	•
4103066	16 EWR	0-150	0-6"	0.01 / .0005"	0.03	.001"	DIN 862	rectangular	
4103067	16 EWR	0-150	0-6"	0.01 / .0005"	0.03	.001"	DIN 862	rectangular	•
4103068	16 EWR	0-200	0-8"	0.01 / .0005"	0.03	.001"	DIN 862	rectangular	
4103069	16 EWR	0-200	0-8"	0.01 / .0005"	0.03	.001"	DIN 862	rectangular	•
4103070	16 EWR	0-300	0-12"	0.01 / .0005"	0.04	.0015"	Factory standard		
4103071	16 EWR	0-300	0-12"	0.01 / .0005"	0.04	.0015"	Factory standard		•

Order no.	a	b	c	d	e
	mm	mm	mm	mm	mm
4103064	10	40	16	235	16
4103065	10	40	16	235	16
4103066	10	40	16	235	16
4103067	10	40	16	235	16
4103068	10	50	19	285	16
4103069	10	50	19	285	16
4103070	14	64	19	388	16
4103071	14	64	19	388	16

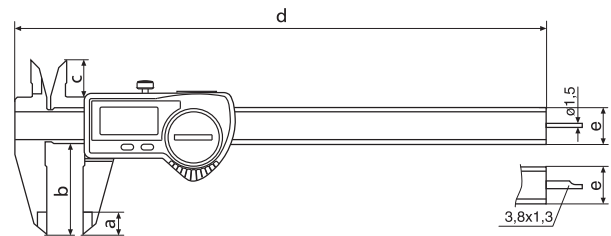

ACCESSORIES

Order no.	Product name	Type
4102020	Depth bridge (75 x 7 mm)	16 Em
4102357	16 EXu data connection cable USB (2 m)	16 EXu
4102410	Data connection cable RS232C (2 m)	16 EXr
4102520	Battery 3 V, CR 2032	
4102915	Digimatic data cable (2 m)	16 EWd

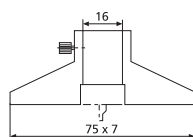

16 Em